

MCCB Inner Accessories

HGP160D, HGP250~800

Auxiliary switch (AUX)
Alarm switch (ALT)
Shunt trip (SHT)
Under voltage trip (UVT)

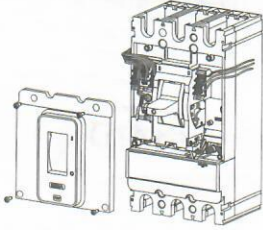

현대일렉트릭

울산광역시 동구 방어진순환도로 700
A/S 센터 : Tel)080-230-7778 / 052-202-7777
홈페이지 : www.hyundai-elec.com

HYUNDAI ELECTRIC

700 Bangeojinsunhwando-ro, Dong-gu, Ulsan, Korea
A/S center : Tel)080-230-7778 / 052-202-7777
Homepage : www.hyundai-elec.com

주의

- 제품을 설치하기 전 주의사항을 반드시 읽고 설명에 따라 설치하여 주십시오.
- 차단기의 설치 및 보수는 유자격자(전기공사자)가 행하여 주십시오. 잘못된 설치로 인한 오동작 또는 사고가 발생할 위험이 있습니다.

CAUTION

- Before installation, be sure to read the manual carefully to ensure proper operation
- Installation, maintenance and inspection of the circuit breaker should be performed by persons who are qualified for electric work.

CUIDADO

- Antes da instalação, certifique-se de ler atentamente o manual e entender os procedimentos para o funcionamento adequado
- A instalação, manutenção e inspeção do disjuntor deve ser realizada por pessoas qualificadas para o trabalho elétrico.

PRECAUCION

- Antes de la instalación, asegúrese de leer el manual cuidadosamente y comprenda los procedimientos para la apropiada operación
- La instalación, mantenimiento e inspección del interruptor automático debe ser realizada por personas cualificadas para el trabajo eléctrico.

ПРЕДУПРЕЖДЕНИЕ

- Перед установкой, внимательно прочтите инструкцию по эксплуатации и ознакомьтесь с порядком выполнения необходимых условий и процедур для корректной работы оборудования.
- Установка, ремонт и осмотр автоматического выключателя должен выполняться квалифицированным специалистом по электрооборудованию.

Part list

	AUX16GP AUX63GP	ALT16GP	ALT25GP ALT63GP	SHT16GP	UVT16GP	SHT25GP	UVT25GP	SHT63GP	UVT63GP
MODEL (MCCB)	HGP160D HGP250 HGP630 HGP800	HGP160D	HGP250 HGP630 HGP800	HGP160D	HGP160D	HGP250	HGP250	HGP630 HGP800	HGP630 HGP800
	1	-	1	-	-	-	-	-	-
	-	1	-	-	-	-	-	-	-
	-	-	-	1	1	-	-	-	-
	-	-	-	-	-	1	1	-	-
	-	-	-	-	-	-	-	1	1
	-	-	-	(1)*	1	-	1	-	1
	-	-	-	-	-	1	1	1**	1**
	-	-	-	-	-	1	1	1	1

* DC Voltage only
** HGP800 is not used.

Installation

1 Open the front cover

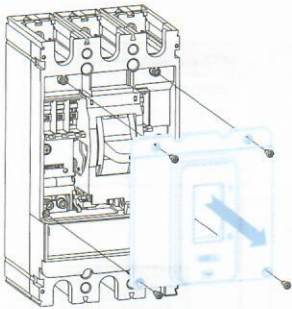

2-1 SHT & UVT COIL ASSEMBLY

Assemble the circuit breaker trip state.
Handle to the on position, then assembled SHT & UVT.

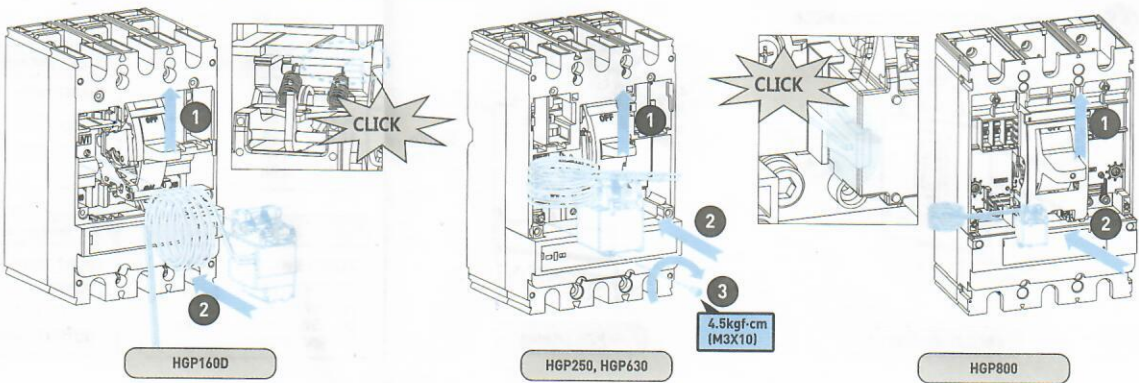

Caution

Check the operation of the assembled SHT/UVT coil.

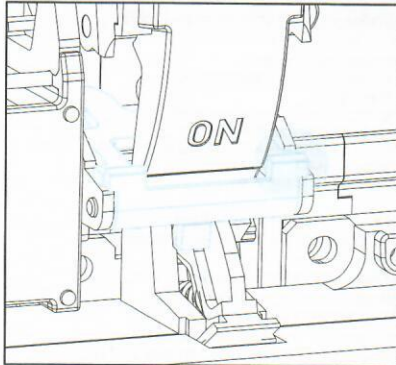

1. 별도 표시된 MCCB 메카니즘 부품의 상태(TRIP)를 확인하십시오.
1. Check the state(TRIP) of MCCB mechanism part as shown in the illustration.

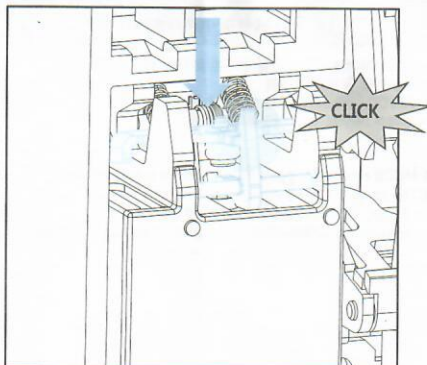

2. SHT/UVT coil의 별도 표시된 부품을 눌러 그림과 같이 동작되는지 확인하십시오.
2. Push the mechanism part of SHT/UVT coil, then check the operation as shown in the illustration.

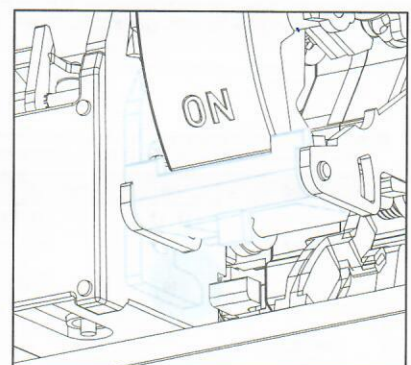

3. SHT/UVT coil의 레버가 MCCB 그림과 같이 메카니즘 부품보다 뒤에 있는지 확인하십시오.
3. Check the position of SHT/UVT coil lever as shown in the illustration.

Installation

2-2 AUX ASSEMBLY

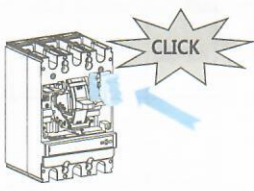

HGP160D

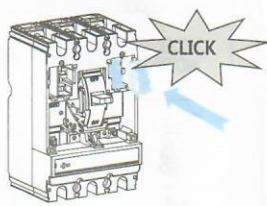

HGP250

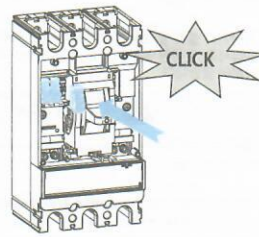

HGP630

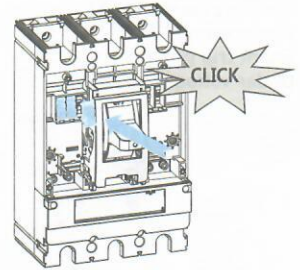

HGP800

2-3 ALT ASSEMBLY

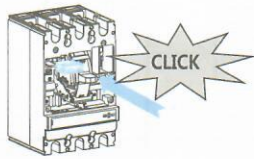

HGP160D

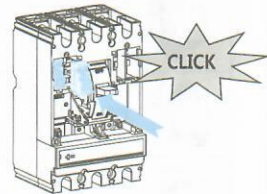

HGP250

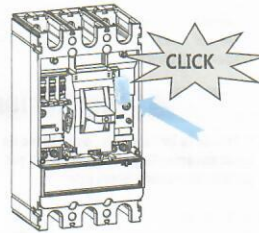

HGP630

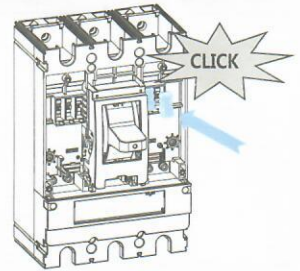

HGP800

3 Cut the front cover as shown in the figure.

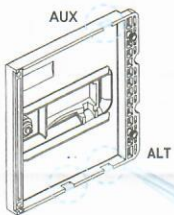

HGP160D

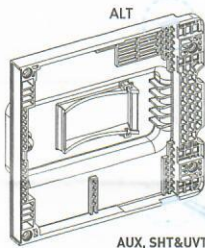

HGP250

4 Close the front cover, Be careful not to damage lead-wire.

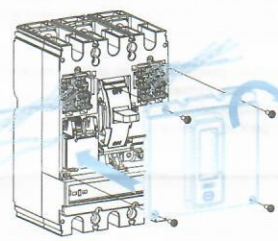

HGP160D, UPB250

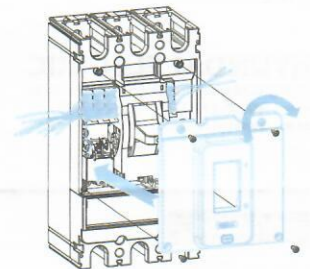

HGP630, HGP800

5 Attach accessory name plate to the MCCB.

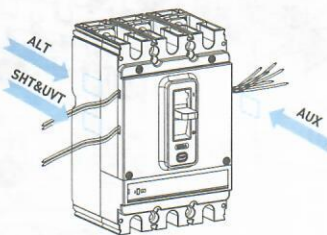

HGP160D, HGP250

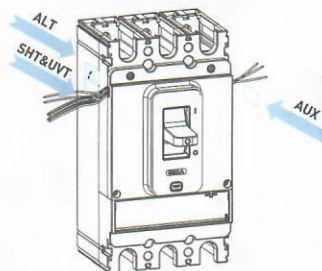

HGP630, HGP800

<p>AUX Name plate</p> <p>AUX. SWITCH</p> <p>AC125V 5A</p> <p>AC250V 3A</p> <p>DC125V 0.4A</p> <p>DC250V 0.2A</p>	<p>SHT Name plate</p> <p>SHUNT TRIP</p> <p>AC440V-480V</p> <p>50/60Hz</p>	<p>UVT Name plate (with controller)</p> <p>UNDERVOLTAGE TRIP</p> <p>INPUT: CONTROLLER</p> <p>AC440-480V 50/60Hz</p> <p>OUTPUT: DC45V SOURCE</p>
<p>ALT Name plate</p> <p>ALARM SWITCH</p> <p>AC125V 5A</p> <p>AC250V 3A</p> <p>DC125V 0.4A</p> <p>DC250V 0.2A</p>	<p>SHT Name plate(with controller)</p> <p>SHUNT TRIP</p> <p>INPUT: CONTROLLER</p> <p>DC 24V</p> <p>OUTPUT: DC45V SOURCE</p>	<p>경격 전압 (rated voltage)</p>

Operating test

Auxiliary switch(AUX) and Alarm switch (ALT)

- 스위치는 아래표에 표기된 사양을 기준으로 하고 MCCB의 동작에 따라 스위치가 동작 할 것.
- AUX and ALT shall comply with the specification in the table and they shall operate according to the position of MCCB

MCCB	ON	OFF	TRIP
Position of AUX			
Position of ALT			

Shunt trip devices (SHT)

- SHT에 아래와 같은 전압을 인가할 때 MCCB가 트립할 것.
- 사용 전압 및 주파수 범위
 - AC/DC 70%~110% Ue (Ue:정격전압)
 - 주파수 : 45Hz~65Hz (교류에만 적용)
- MCCB shall be tripped at the voltage listed below
- The range of rated voltage and frequency
 - AC/DC 70%~110% Ue (Ue:Rated voltage)
 - frequency : 45Hz~65Hz (only applicable to AC voltage)

Under voltage trip devices (UVT)

- 정격 전압의 85%에서 투입 가능할 것.
- 정격 전압의 20~70%, 또는 무전압에서 트립 될 것.
- 사용 전압 및 주파수 범위
 - 투입조작 가능 전압 : $U = 0.85 * U_e$ (Ue:정격전압)
 - Trip 전압 : $U \leq 0.35 * U_e$ (Ue:정격전압)
 - $U = 0.35 - 0.7 * U_e$ 구간에서는 차단기가 Trip 될 수 있으나, 동작을 보증하지는 않습니다.
 - 주파수 : 45Hz~65Hz (교류에만 적용)
- Shall be closed at the 85% of rated voltage
- MCCB shall be tripped at the 20~70% of rated voltage or at no voltage
- The range of rated voltage and frequency
 - Possible voltage for closing operation : $U = 0.85 * U_e$ (Ue:Rated voltage)
 - Trip voltage : $U \leq 0.35 * U_e$ (Ue:Rated voltage)
 - If the supply voltage is between $0.35 * U_e$ and $0.7 * U_e$, opening is possible, but not guaranteed.
 - frequency : 45Hz~65Hz (only applicable to AC voltage)

MCCB의 전면 Cover를 닫은 후 수직 또는 수평위치에서 확인하여 주십시오.
Test with the front cover closed of MCCB in vertical or horizontal position.